

JOLLY BOYS NOTTINGHAM TO BEESTON TRAM TRIP 8th OCTOBER 2015

To celebrate the opening of the Nottingham Tram Extension (only 9 months late) we will be travelling from Nottingham Station to Beeston via the suburb of Lenton.

The Tour

Note: All pubs are in GBG 2015.

Arrival at Nottingham Station (see the attached sketch map to see details).

Exit the station from the front right (not the centre bridge). Cross Carrington Street at the pedestrian crossing and turn left down the ramp. Cross the footbridge over the canal and the Weatherspoons is in the large warehouse with "BRITISH WATERWAYS" in very large letters on the side. If you can't see the wording I suggest you need your eyes testing! Continue to the far end of the warehouse. It is about 5 mins from station.

Pub No 1 The Company Inn

<http://www.jdwetherspoon.co.uk/home/pubs/the-company-inn>

Weatherspoons for breakfasts and earlies until the other pubs open!

It is a standard Weatherspoons situated at the end of the warehouse (after the Glee Club and Fit Space).

Times - until 11.00.

Pub No 2 The Canal House

<http://www.thecanalhouse.co.uk/>

Go down the steps at the end of the warehouse and between the two buildings onto the road. Turn right and then right through the Iron Gates and through the courtyard to the pub.

Note: For those not going to the Company Inn then from the station go down Carrington Street to the traffic lights. Turn left and go past the Fellows (pub 3) and through the Iron Gates.

This is a Castle Rock house with their ales and guests.

Times 11.00 to 11.30.

Pub No 3 Fellows, Morton and Clayton

<http://www.fellowsmortonandclayton.co.uk/>

Next door to the Canal House and is actually named after the building which houses that pub.

This used to have its own brewery but this seems to have stopped. 7 real ales available. Does food but probably a bit early.

Times 11.30 to 12.00.

The Tram Trip (part 1)

<http://www.thetram.net/>

Go back to Nottingham Station and down Station Street to the tram stop over the station. Everyone will need to buy a tram ticket BEFORE boarding the tram (unless you are feeling brave and want to risk the £50 fine if the travelling inspectors catch you). There are no old people discounts except a cheaper return ticket which we will not need as we are not returning! Purchase a £4.00 day ticket as we are doing 2 journeys (cheaper than 2 singles and you can spend the rest of the day travelling on the tram if you want!). Change is available from the machines.

We then catch a tram towards TOTON LANE (not Clifton South). We will get off at GREGORY STREET (3 stops). For those of you who used to be involved in Nottingham Computing the tram passes the site of the demolished Furlong House.

At Gregory Street follow the tram track to the traffic lights and turn left. Walk for about 100 yards to...

Pub No 4 The Johnson Arms

<http://www.johnsonarms.co.uk/>

Nice suburban pub with 5 real ales. This is probably the main food stop as the Victoria will be rather late. Standard range of pub meals and things.

Times 12.30 - 13.15 (this may vary depending on tram times and food).

Historical note: The pub is in Lenton which is where Lenton Priory was situated until the dissolution. There are a few remains and we pass the Priory Church on the way to the pub.

The Tram Trip (part 2).

We walk back to GREGORY STREET and catch the first tram to BEESTON CENTRE (see attached map of Beeston). There is pedestrian access from Styrring Street to Church Street. Take this and arrive at..

Pub No 5 The Crown Inn (A on map)

<https://www.everards.co.uk/our-pubs/crown-inn-beeston/>

Visited last time in Beeston it is a multiple roomed pub with 12 real ales. Does rolls and snacks.

Times 13.45 to 14.15 (depending on tram).

Walk down Dovecote Lane (10 to 15 minutes) to arrive at..

Pub No 6 The Victoria (B on map)

<http://www.victoriabeeston.co.uk/>

Situated next to Beeston Station has lots of real ales and very good food.

Times 14.30 to end.

CAMRA Discounts

These are available at the Canal House, Fellows, Morton and Clayton and the Johnson Arms.

Train Times

London St P d	08:15	08:29	09:15	09:29
Nottingham a	09:54	10:18	10:55	11:18

Beeston d	14:11	14:25	15:11	15:25	16:11
London St P a	15:56	16:32	16:56	17:29	17:56
Change at	Direct	Derby	Direct	Derby	Direct

Or alternatively have a tram ride back to Nottingham and beyond!

Or even more alternatively - This year's trip coincides with the Nottingham Beer Festival <http://www.beerfestival.nottinghamcamra.org/> so catch the tram back to Nottingham Town Centre and go to the Castle for over 1,000 real ales!

Map 1 Nottingham Station Sketch Map (please excuse lack of tidiness)

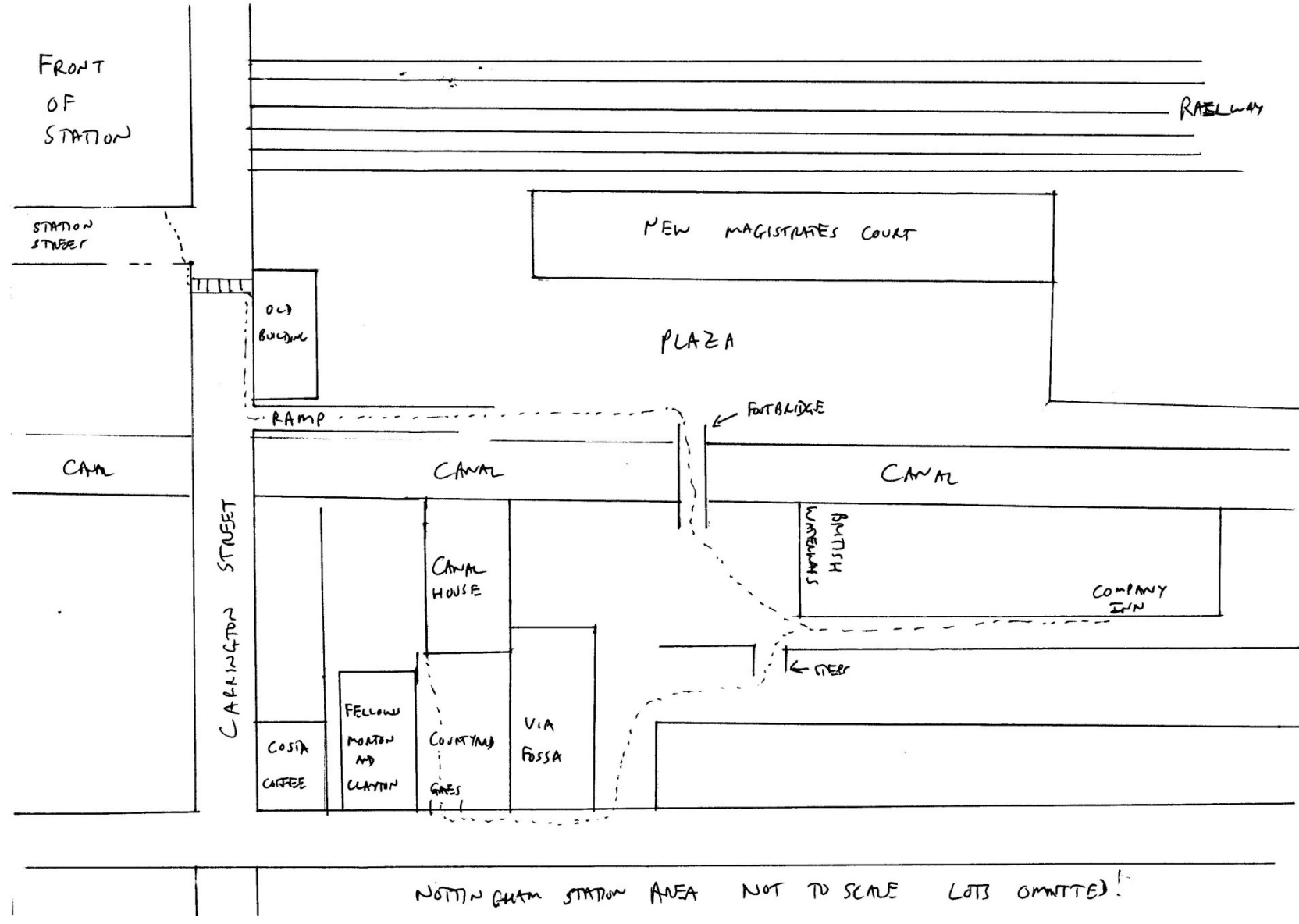

Map 2 Beeston Town Centre

